



# ULT Freezers



**Haier Medical & Laboratory Solutions America LLC**

Website: [www.haiermedical-usa.com](http://www.haiermedical-usa.com)

Jun, 2026

**Haier Biomedical**  
Intelligent Protection of Life Science



## Cryogenic ULT Freezer | DW-150W209A

01-02



- 100% hydrocarbon refrigeration technology
- Low noise operation
- High energy efficiency
- Safe and reliable
- Safe & reliable performance

## UltraEco ULT Freezer | DW-86L580/730/830/960BPT

03-07



- Ultra-low energy consumption
- Superior performance
- 10" intuitive LCD touchscreen
- Ultra-low carbon footprint
- Safe and reliable

## TwinCool ULT Freezer | DW-86L578/728/828BPST

08-09



- Inverter dual compressor system
- Superior performance
- 10" intuitive LCD touchscreen
- Ultra-low carbon footprint
- Safe and reliable

## SmartEco ULT Freezer | DW-86L579/729/829/959BPT

10-11



- Inverter compressor system
- Superior uniformity
- 10" intuitive LCD touchscreen
- Enhanced secure access
- Reliable performance

## Standard ULT Freezer | DW-80WZ15 / DW-86L51J/100J/338J/578J/728J

12-14



- Flexible capacity options
- Efficient & durable design
- Reliable performance
- Comprehensive safety features

## ► Exterior and Interior View



## ► Product Advantages



### Energy Efficient Hydrocarbon Refrigeration

- Includes specialist industrial compressor, hydrocarbon refrigerant, dual-compressors 4-stage cascade refrigeration system, which delivers excellent energy-efficiencies
- Energy-efficient fan design with intelligent start/stop



### Environmentally Friendly

- 100% HC refrigerant truly environmentally-friendly refrigeration system with zero global warming potential (GWP)
- Eco-friendly insulation has a low GWP, substantially lower than most conventional HFCs, delivering improved environmental performance



### Superior Uniformity

The temperature uniformity is  $\pm 5^{\circ}\text{C}$  with the setting temperature of  $-150^{\circ}\text{C}$



### Safe, Secure and Reliable

Multiple alarms, including high and low temperature, power failure, door ajar, hot condenser, low battery, sensor error, and high ambient temperature. The standard ambient temperature ranges from  $10^{\circ}\text{C}$  to  $32^{\circ}\text{C}$ . The pressure state of the system can be automatically adjusted by the pressure controller to prevent the pressure from being too high to effect the freezer operation.



### Low Noise

Noise-reduction features and design keep noise level at 55 dB(A)

## Specifications

Model		DW-150W209A	
Technical Data	Cabinet Type	Chest	
	Ambient Temperature (°C)	10-28	
	Cooling Type	Direct Cooling	
	Defrost Mode	Manual	
	Refrigerant	HC	
	Sound Level (dB(A))	55	
Performance	Cooling Performance (°C)	-150	
	Temperature Range (°C)	-140~-150	
Control	Controller	Microprocessor	
	Display	LCD Touchscreen	
Electrical Data	Power Supply (V/Hz)	208-230/60	
	Max Power (W)	2000	
Dimensions	Capacity (L/Cu.Ft)	209/7.4	
	Net/Gross Weight (approx)	kg	260/295
		lbs	573.2/650.4
	Interior Dimensions (W×D×H)	mm	667×462×677
		in	26.3×18.2×26.7
	Exterior Dimensions (W×D×H)	mm	1650×860×1010
		in	65.0×33.9×39.8
	Packing Dimensions (W×D×H)	mm	1810×960×1170
in		71.3×37.8×46.1	
Container Load (20'/40'/40'H)	12/24/24		
Alarms	High/Low Temperature	Y	
	Hot Condenser	Y	
	Power Failure	Y	
	High/Low Voltage	Y	
	Sensor Error	Y	
	Low Battery	Y	
	High Ambient Temperature	Y	
	Door Ajar	Y	
	Start-Up Delay	Y	
Accessories	Caster	Y	
	Leveling Feet	Y	
	Porthole	1×rear, (25mm) diameter	
	Inner Doors	2	
	Shelves	N/A	
	Shelf Dimensions (W×D)(mm)	N/A	
	Max. Load per Shelf (kg)	N/A	
	Freezer Racks Quantity (2" boxes)	12	
	Capacity (2" boxes)	144	
	USB Interface	Y	
	Remote Alarm	Y	
	5V Power Supply Port	Y	
	Temperature Chart Recorder	Optional	
	RS232/485 Port	N/A/Standard	
	CO <sub>2</sub> Backup System	N/A	
LN <sub>2</sub> Backup System	Optional		
Others	Certification	UL	

## ► Exterior and Interior View



## ► Product Advantages



World's No.1\*  
Energy Efficiency



Ultra-Low  
Carbon Footprint



Superior  
Performance



Uncompromising  
Safeguards



User-Centric  
Convenience

\*Based on ENERGY STAR certified ULT freezer energy data (as of Feb. 2026)

## ► Optimal Energy Efficient Performance

The UltraEco ULT freezer – an ultra-low impact, greener alternative for cold storage

The UltraEco ULT freezer combines a hydrocarbon refrigerant, inverter compressor technology and new sustainable material science to significantly reduce electricity consumption:

### Power Consumption (kWh/year/2"cryobox)

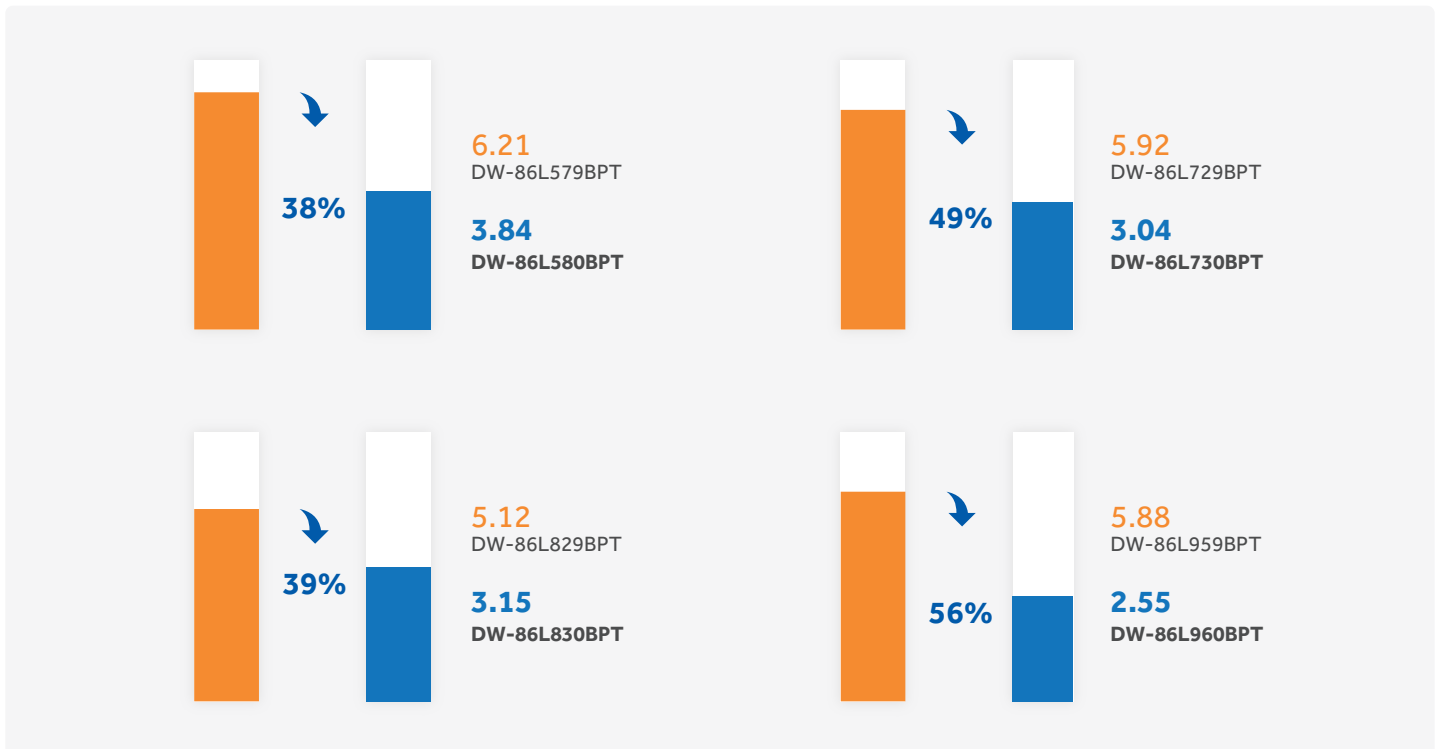

## ► Enhanced Performance

An upgraded compressor, enhanced refrigeration system and new sustainable insulation material deliver a range of benefits compared to the previous generation of ULT freezers.

**49%**  
Decrease in Energy Consumption

**15 min**  
1 Min Door Opening Recovery Time

**80%**  
Faster Re-Entry Time

**1 hour**  
Improvement in warm-up time from -80 to -50°C

**42dB(A)**  
Lower Sound Level

**±2°C**  
Outstanding Temperature Uniformity

\*Above data based on DW-86L730BPT

## ➤ Green and Environmental Friendly



Naturally occurring hydrocarbon refrigerants and insulation materials are a feature of the UltraEco ULT freezer – the first of its kind in this sector. These non-toxic, eco-friendly materials are more sustainable, non-ozone depleting and reduce the carbon footprint, providing a greener, more environmentally- friendly insulation solution than other current generation freezers.

## ➤ Safety and Reliability

- Dual sensors deliver precise temperature change detection, doubling sample storage security.
- The compressor's self-diagnostic function triggers instant alarms upon malfunctions, enabling prompt maintenance to prevent sample damage.
- Optimized VIP insulation ensures extended thermal retention, safeguarding samples during brief power outages.
- Optional built-in backup system and independent control panel guarantee sample safety, even during extended power outages.

## ➤ Ergonomic Design



### 10.1 Inch Capacitive Touch Screen

State-of-art UI design coupled with sample management system to provide the optimal user experience



### Innovative Light Bar Design

Clearly indicate the operating status of the freezer and offer strengthened visual alarm indications for effortless at-a-glance monitoring



### Improved Pressure Relief Port

Re-entry time shortened to just 60 seconds



### USB Interface

Enables users to download historical temperature data for compliance/ auditing purposes

## ► Performance Curve

### Temperature Pull-down & Pull-up Curves at 20°C Ambient

— Pull-down  
— Pull-up

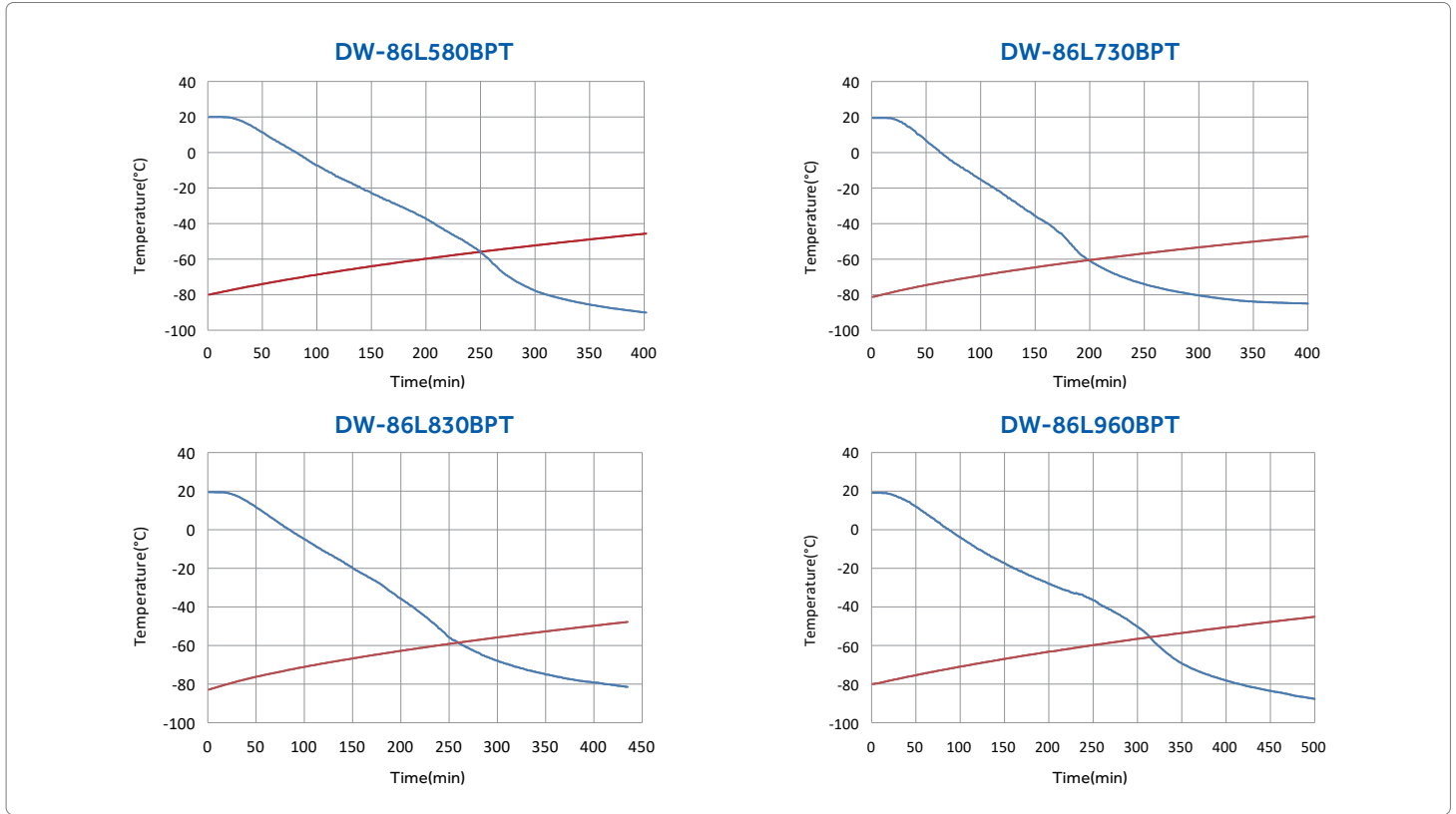

## ► Product Dimensions

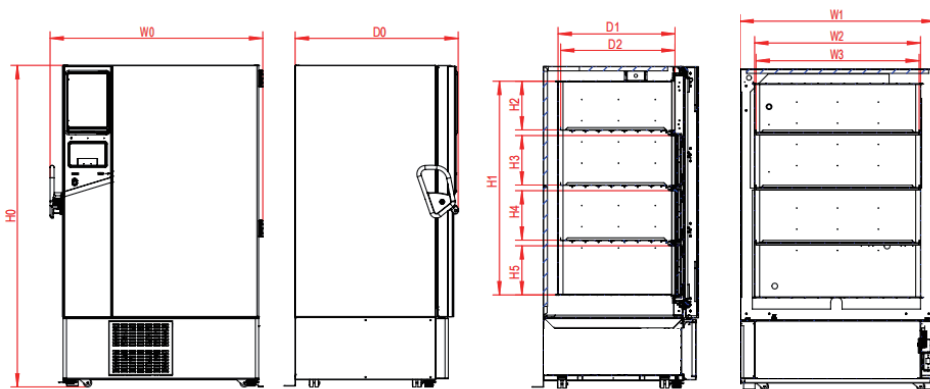

### Remark

- W0 ----- Overall Unit Width
- W1 ----- Cabinet Exterior Width
- W2 ----- Inner Liner Width
- W3 ----- Shelf Clear Width (for freezer racks)
- D0 ----- Overall Unit Depth
- D1 ----- Inner Liner Depth
- D2 ----- Maximum Item Storage Depth
- H0 ----- Overall Unit Height
- H1 ----- Inner Liner Height
- H2 ----- 1st Layer Height
- H3 ----- 2nd Layer Height
- H4 ----- 3rd Layer Height
- H5 ----- 4th Layer Height

Code Model	W0/mm	W1/mm	W2/mm	W3/mm	H0/mm	H1/mm	H2/mm	H3/mm	H4/mm	H5/mm	D0/mm	D1/mm	D2/mm
DW-86L580BPT	895	800	620	604	1970	1310	298	303	303	301	998	716	700
DW-86L730BPT	1046	946	766	750	1970	1310	298	303	303	301	998	716	700
DW-86L830BPT	1145	1050	870	854	1970	1310	298	303	303	301	998	716	700
DW-86L960BPT	1296	1196	1016	999	1970	1310	298	303	303	301	998	716	700

## ► Specifications

Model		DW-86L580BPT	DW-86L730BPT	DW-86L830BPT	DW-86L960BPT	
Technical Data	Cabinet Type	Upright	Upright	Upright	Upright	
	Ambient Temperature (°C)	10-32	10-32	10-32	10-32	
	Cooling Type	Direct Cooling	Direct Cooling	Direct Cooling	Direct Cooling	
	Defrost Mode	Manual	Manual	Manual	Manual	
	Refrigerant	HC	HC	HC	HC	
	Sound Level (dB(A))	≤42	≤42	≤46	≤40	
Performance	Cooling Performance (°C)	-86	-86	-86	-86	
	Temperature Range (°C)	-40--86	-40--86	-40--86	-40--86	
Control	Controller	Microprocessor	Microprocessor	Microprocessor	Microprocessor	
	Display	LCD Touchscreen	LCD Touchscreen	LCD Touchscreen	LCD Touchscreen	
Electrical Data	Power Supply (V/Hz)	100-230/50/60	100-230/50/60	100-230/50/60	100-230/50/60	
	Max Power (W)	800	900	1050	900	
Dimensions	Capacity (L/Cu.Ft)	580/20.5	730/25.8	830/29.3	960/33.9	
	Net/Gross Weight	kg	287/326	315/368	336/390	375/426
		lbs	632.7/718.7	694.5/811.3	740.8/859.8	826.7/939.2
	Interior Dimension (W×D×H)	mm	620×716×1310	766×716×1310	870×716×1310	1016×716×1310
		in	24.4×28.2×51.6	30.2×28.2×51.6	34.3×28.2×51.6	40.0×28.2×51.6
	Exterior Dimension (W×D×H)	mm	895×998×1970	1046×998×1970	1145×998×1970	1296×998×1970
		in	35.2×39.3×77.6	41.2×39.3×77.6	45.1×39.3×77.6	51.0×39.3×77.6
	Packing Dimension (W×D×H)	mm	960×1150×2160	1110×1150×2160	1220×1150×2160	1400×1150×2160
		in	37.8×45.3×85	43.7×45.3×85	48×45.3×85	55.1×45.3×85
	Cabinet Width (without handle and hinge)	mm	800	946	1050	1196
Container Load (20'/40'/40'H)		12/24/24	10/20/20	8/20/20	8/16/16	
Functions	High/Low Temperature Alarm	Y	Y	Y	Y	
	Hot Condenser Alarm	Y	Y	Y	Y	
	Power Failure Alarm	Y	Y	Y	Y	
	High/Low Voltage Alarm	Y	Y	Y	Y	
	Sensor Error Alarm	Y	Y	Y	Y	
	Low Battery Alarm	Y	Y	Y	Y	
	High Ambient Temperature Alarm	Y	Y	Y	Y	
	Door Ajar Alarm	Y	Y	Y	Y	
	Start-up Delay	Y	Y	Y	Y	
Accessories	Caster	Y(4)	Y(4)	Y(4)	Y(4)	
	Leveling Feet	Y(2)	Y(2)	Y(2)	Y(2)	
	Porthole	2×rear, (15mm)diameter	2×rear, (15mm)diameter	2×rear, (15mm)diameter	2×rear, (15mm)diameter	
	Inner Doors	4	4	4	4	
	Shelves	3- stainless steel adjustable shelves	3- stainless steel adjustable shelves	3- stainless steel adjustable shelves	3- stainless steel adjustable shelves	
	Shelf Dimensions (W×D)(mm)	606×650	752×650	856×650	1002×650	
	Max. Load per Shelf (kg)	72	90	108	126	
	Freezer Racks Qty (2" boxes)	16	20	24	28	
	Capacity (2" boxes)	400	500	600	700	
	USB Interface	Y	Y	Y	Y	
	Remote Alarm	Y	Y	Y	Y	
	5V Power Supply Port	Y	Y	Y	Y	
	Temperature Chart Recorder	Optional	Optional	Optional	Optional	
	RS232/485 Port	N/A/Standard	N/A/Standard	N/A/Standard	N/A/Standard	
	CO <sub>2</sub> Backup System	Optional	Optional	Optional	Optional	
	LN <sub>2</sub> Backup System	Optional	Optional	Optional	Optional	
Other	Certifications	UL, ENERGY STAR	UL, ENERGY STAR	UL, ENERGY STAR	UL, ENERGY STAR	

\*Haier Biomedical reserves the right to change products and specifications without prior notice.

## ► Exterior and Interior View



DW-86L578BPST/728BPST/828BPST

## ► Product Advantages

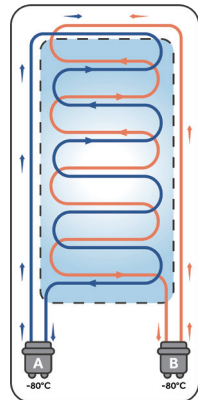

### Dual refrigeration system for optimal reliability and security

Double independent hydrocarbon refrigeration system design, each system can maintain  $-80^{\circ}\text{C}$  ensuring the safety of stored samples



### Environmental Protection

Natural hydrocarbon refrigerants and eco-friendly insulation greatly reduce the carbon footprint



### World-leading Energy Saving Refrigeration Technology

Intelligent frequency conversion technology and HC refrigeration system delivers a 50% reduction in energy usage when compared to traditional HFC refrigeration systems

**► Specifications**

Model		DW-86L578BPST	DW-86L728BPST	DW-86L828BPST	
Technical Data	Cabinet Type	Upright	Upright	Upright	
	Ambient Temperature (°C)	10-32	10-32	10-32	
	Cooling Type	Direct Cooling	Direct Cooling	Direct Cooling	
	Defrost Mode	Manual	Manual	Manual	
	Refrigerant	HC	HC	HC	
	Sound Level (dB(A))	42	42	42	
Performance	Cooling Performance(°C)	-86	-86	-86	
	Temperature Range (°C)	-40~-86	-40~-86	-40~-86	
Control	Controller	Microprocessor	Microprocessor	Microprocessor	
	Display	LCD Touchscreen	LCD Touchscreen	LCD Touchscreen	
Electrical Data	Power Supply(V/Hz)	100~230/50/60	100~230/50/60	100~230/50/60	
	Max Power (W)	1100	1100	1400	
Dimensions	Capacity (L/Cu.Ft)	578/20.4	728/25.7	828/29.2	
	Net/Gross Weight (approx)	kg	325/355	350/385	380/410
		lbs	716.5/782.6	771.6/848.8	837.7/914.9
	Interior Dimensions (W×D×H)	mm	620×716×1310	766×716×1310	870×716×1310
		in	24.4×28.2×51.6	30.2×28.2×51.6	34.3×28.2×51.6
	Exterior Dimensions (W×D×H)	mm	895×998×1980	1046×998×1980	1145×998×1980
		in	35.2×39.3×78.0	41.2×39.3×78.0	45.1×39.3×78.0
	Packing Dimensions (W×D×H)	mm	953×1071×2127	1105×1066×2117	1200×1080×2130
		in	37.5×42.1×83.7	43.5×42×83.3	47.2×42.5×83.9
	Cabinet Width (without handle and hinge)	mm	800	946	1050
Container Load(20'/40'/40'H)		12/24/24	10/20/20	8/20/20	
Alarms	High/Low Temperature	Y	Y	Y	
	Hot Condenser	Y	Y	Y	
	Power Failure	Y	Y	Y	
	High/Low Voltage	Y	Y	Y	
	Sensor Error	Y	Y	Y	
	Low Battery	Y	Y	Y	
	High Ambient Temperature	Y	Y	Y	
	Door Ajar	Y	Y	Y	
	Start-Up Delay	Y	Y	Y	
Accessories	Caster	Y	Y	Y	
	Leveling Feet	Y	Y	Y	
	Porthole	2×rear, (25mm) diameter	2×rear, (25mm) diameter	2×rear, (25mm) diameter	
	Inner Doors	4	4	4	
	Shelves	3- Stainless Steel Adjustable Shelves	3- Stainless Steel Adjustable Shelves	3- Stainless Steel Adjustable Shelves	
	Shelf Dimensions (W×D)(mm)	606×650	752×650	856×650	
	Max. Load per Shelf (kg)	72	90	108	
	Freezer Racks Quantity (2" boxes)	16	20	24	
	Capacity (2" boxes)	400	500	600	
	USB Interface	Y	Y	Y	
	Remote Alarm	Y	Y	Y	
	5V Power Supply Port	Y	Y	Y	
	Temperature Chart Recorder	Optional	Optional	Optional	
	RS232/485 Port	N/A/Standard	N/A/Standard	N/A/Standard	
	CO <sub>2</sub> Backup System	Optional	Optional	Optional	
LN <sub>2</sub> Backup System	Optional	Optional	Optional		
Others	Certification	UL, ENERGY STAR	UL, ENERGY STAR	UL, ENERGY STAR	

\*Haier Biomedical reserves the right to change products and specifications without prior notice.

## ► Exterior and Interior View



**DW-86L579BPT/729BPT/829BPT/959BPT**

## ► Product Advantages



### Intelligent Frequency Conversion Technology

Two variable speed compressors are controlled for optimal freezer performance. Low energy consumption is achieved.



### World-Leading Energy Saving Refrigeration Technology

Our hydrocarbon refrigeration technology reducing operator' s cost. The refrigerants global warming potential is extremely low, which is very friendly to the environment.



### Precise Temperature Control

The innovative control algorithm balance the effects of tempwith the unique frequency conversion refrigeration system, ensuring the cabinet temperature stability of  $\pm 3^{\circ}\text{C}$ .



### Minimal Sound Level Output

Adaptive control technology controls the fans and compressors to reduce the sound level to 43.5 dB(A).

## Specifications

Model		DW-86L579BPT	DW-86L729BPT	DW-86L829BPT	DW-86L959BPT	
Technical Data	Cabinet Type	Upright	Upright	Upright	Upright	
	Ambient Temperature (°C)	10-32	10-32	10-32	10-32	
	Cooling Type	Direct Cooling	Direct Cooling	Direct Cooling	Direct Cooling	
	Defrost Mode	Manual	Manual	Manual	Manual	
	Refrigerant	HC	HC	HC	HC	
	Sound Level (dB(A))	43.5	43.5	43.5	47	
Performance	Cooling Performance(°C)	-86	-86	-86	-86	
	Temperature Range (°C)	-40~-86	-40~-86	-40~-86	-40~-86	
Control	Controller	Microprocessor	Microprocessor	Microprocessor	Microprocessor	
	Display	LCD Touchscreen	LCD Touchscreen	LCD Touchscreen	LCD Touchscreen	
Electrical Data	Power Supply(V/Hz)	100-230/50/60	100-230/50/60	100-230/50/60	100-230/50/60	
	Max Power (W)	1100	1100	1400	1750	
Dimensions	Capacity (L/Cu.Ft)	579/20.4	729/25.7	829/29.2	959/33.9	
	Net/Gross Weight (approx)	kg	320/350	350/385	380/415	450/485
		lbs	705.5/771.6	771.6/848.8	837.8/914.9	992.1/1069.2
	Interior Dimensions (W×D×H)	mm	620×716×1310	766×716×1310	870×716×1310	1016×716×1310
		in	24.4×28.2×51.6	30.2×28.2×51.6	34.3×28.2×51.6	40.0×28.2×51.6
	Exterior Dimensions (W×D×H)	mm	895×998×1980	1046×998×1980	1145×998×1980	1296×998×1980
		in	35.2×39.3×78.0	41.2×39.3×78.0	45.1×39.3×78.0	51.0×39.3×78.0
	Packing Dimensions (W×D×H)	mm	953×1071×2127	1105×1066×2117	1204×1072×2125	1365×1102×2164
		in	37.5×42.2×83.8	43.5×42×83.3	47.4×42.2×83.7	53.7×43.4×85.2
	Cabinet Width (without handle and hinge)	mm	800	946	1050	1196
Container Load (20'/40'/40'H)		12/24/24	10/20/20	8/20/20	8/16/16	
Alarms	High/Low Temperature	Y	Y	Y	Y	
	Hot Condenser	Y	Y	Y	Y	
	Power Failure	Y	Y	Y	Y	
	High/Low Voltage	Y	Y	Y	Y	
	Sensor Error	Y	Y	Y	Y	
	Low Battery	Y	Y	Y	Y	
	High Ambient Temperature	Y	Y	Y	Y	
	Door Ajar	Y	Y	Y	Y	
	Start-Up Delay	Y	Y	Y	Y	
Accessories	Caster	Y	Y	Y	Y	
	Leveling Feet	Y	Y	Y	Y	
	Porthole	2×rear, (25mm) diameter	2×rear, (25mm) diameter	2×rear, (25mm) diameter	2×rear, (25mm) diameter	
	Inner Doors	4	4	4	4	
	Shelves	3- Stainless Steel Adjustable Shelves	3- Stainless Steel Adjustable Shelves	3- Stainless Steel Adjustable Shelves	3- Stainless Steel Adjustable Shelves	
	Shelf Dimensions (W×D)(mm)	596×657	752×650	856×650	1002×650	
	Max. Load per Shelf (kg)	72	90	108	126	
	Freezer Racks Quantity (2" boxes)	16	20	24	28	
	Capacity (2" boxes)	400	500	600	700	
	USB Interface	Y	Y	Y	Y	
	Remote Alarm	Y	Y	Y	Y	
	5V Power Supply Port	Y	Y	Y	Y	
	Temperature Chart Recorder	Optional	Optional	Optional	Optional	
	RS232/485 Port	N/A/Standard	N/A/Standard	N/A/Standard	N/A/Standard	
	CO <sub>2</sub> Backup System	Optional	Optional	Optional	Optional	
	LN <sub>2</sub> Backup System	Optional	Optional	Optional	Optional	
Others	Certification	UL, ENERGY STAR	UL, ENERGY STAR	UL, ENERGY STAR	UL, ENERGY STAR	

\*Haier Biomedical reserves the right to change products and specifications without prior notice.

## ► Exterior View



## ► Interior View



## ► Product Advantages



### Microprocessor Control System

Microprocessor control with adjustable LED temperature display; can be set from -40°C to -86°C



### Low Sound Level

Specialized refrigeration system design using whisper quiet fan and compressors.



### High-Efficiency and Energy-Saving Compressor

High-efficiency HC compressor and optimized refrigeration system, for safe and reliable cold storage of your samples.



### Enhanced Safety

Malfunction alarms including high and low temperature, power failure, sensor error, clean-filter, and high ambient temperature. Capable of producing two types of alarm outputs: audible buzzer and visible flashing light.

## Specifications

Model		DW-80WZ15	DW-86L51J	DW-86L100J	
Technical Data	Cabinet Type	Chest	Upright	Upright	
	Ambient Temperature (°C)	10-32	10-32	10-32	
	Cooling Type	Direct cooling	Direct cooling	Direct cooling	
	Defrost Mode	Manual	Manual	Manual	
	Refrigerant	HC	HC	HC	
	Sound Level (dB(A))	60	46.8	46.8	
Performance	Cooling Performance (°C)	-80	-86	-86	
	Temperature Range (°C)	-60~-80	-40~-86	-40~-86	
Control	Controller	Microprocessor	Microprocessor	Microprocessor	
	Display	LED	LED	LED	
Electrical Data	Power Supply (V/Hz)	110/60, DC24	120/60	120/60	
	Max Power (W)	280	750	680	
Dimensions	Capacity (L/Cu.Ft)	15/0.53	51/1.8	100/3.5	
	Net/Gross Weight (approx)	kg	27/33	77/90	108/132
		lbs	59.5/72.8	169.8/198.4	238/291
	Interior Dimensions (W×D×H)	mm	260×180×330	330×481×316	330×481×630
		in	10.2×7.1×13.0	13×18.9×12.4	13.0×18.9×24.8
	Exterior Dimensions (W×D×H)	mm	690×320×500	532×640×806	770×660×810
		in	27.2×12.6×19.7	20.9×25.2×31.7	30.3×26.0×31.9
	Packing Dimensions (W×D×H)	mm	805×430×725	570×735×1010	830×730×1000
		in	31.7×17.0×28.5	22.4×28.9×39.8	32.7×28.7×39.4
Cabinet Width (without handle and hinge)	mm	N/A	470	520	
Container Load(20'/40'/40'H)		105/210/210	64/120/120	44/88/88	
Functions	High/Low Temperature Alarm	Y	Y	Y	
	Hot Condenser Alarm	N/A	Y	Y	
	Power Failure Alarm	Y	Y	Y	
	High/Low Voltage Alarm	N/A	Y	Y	
	Sensor Error Alarm	Y	Y	Y	
	Low Battery Alarm	N/A	Y	Y	
	High Ambient Temperature Alarm	N/A	Y	Y	
	Door Ajar Alarm	N/A	Y	Y	
Start-up delay	N/A	Y	Y		
Accessories	Caster	N/A	Y(4)	Y(4)	
	Leveling feet	Y(4)	Y(2)	Y(2)	
	Porthole	N/A	1×right side, (25mm)diameter	1×left side, (25mm)diameter	
	Inner Doors	N/A	1	2	
	Shelves	N/A	1- stainless steel adjustable shelves	1- stainless steel adjustable shelves	
	Shelf Dimensions(W×D)(mm)	N/A	316×424	316×424	
	Max. Load per Shelf(kg)	N/A	22	22	
	Freezer Racks Qty(2" boxes)	N/A	2	4	
	Capacity(2" boxes)	10	30	60	
	USB Interface	Optional	Y	Y	
	Remote Alarm	N/A	Y	Y	
	5V Power Supply Port	N/A	N/A	Y	
	Temperature Chart Recorder	N/A	N/A	N/A	
	RS232/485 Port	N/A	N/A/N/A	N/A/Standard	
	CO <sub>2</sub> Backup System	N/A	N/A	Optional	
LN <sub>2</sub> Backup System	N/A	N/A	Optional		
Others	Certification	UL	UL	UL	

\*Haier Biomedical reserves the right to change products and specifications without prior notice.

## Specifications

Model		DW-86L338J	DW-86L578J	DW-86L728J	
Technical Data	Cabinet Type	Upright	Upright	Upright	
	Ambient Temperature (°C)	10-32	10-32	10-32	
	Cooling Type	Direct cooling	Direct cooling	Direct cooling	
	Defrost Mode	Manual	Manual	Manual	
	Refrigerant	HC	HC	HC	
	Sound Level (dB(A))	50	50	50	
Performance	Cooling Performance (°C)	-86	-86	-86	
	Temperature Range (°C)	-40~-86	-40~-86	-40~-86	
Control	Controller	Microprocessor	Microprocessor	Microprocessor	
	Display	LED	LED	LED	
Electrical Data	Power Supply (V/Hz)	120/60	120/60	120/60	
	Max Power (W)	900	900	1700	
Dimensions	Capacity (L/Cu.Ft)	338/11.9	578/20.4	728/25.7	
	Net/Gross Weight (approx)	kg	238/278	300/330	345/385
		lbs	524.7/612.9	661.4/727.5	760.6/848.8
	Interior Dimensions (W×D×H)	mm	465×630×1165	620×716×1310	766×716×1310
		in	18.3×24.8×45.9	24.4×28.2×51.6	30.2×28.2×51.6
	Exterior Dimensions (W×D×H)	mm	830×893×1846	903×980×1960	1049×980×1980
		in	32.7×35.2×72.7	35.6×38.6×77.2	41.3×38.6×78.0
	Packing Dimensions (W×D×H)	mm	879×974×2013	952×1063×2089	1100×1069×2130
		in	34.6×38.3×79.3	37.5×41.9×82.2	43.3×42.1×83.9
	Cabinet Width (without handle and hinge)	mm	725	800	946
Container Load(20'/40'/40'H)		12/24/24	12/24/24	12/20/20	
Functions	High/Low Temperature Alarm	Y	Y	Y	
	Hot Condenser Alarm	Y	Y	Y	
	Power Failure Alarm	Y	Y	Y	
	High/Low Voltage Alarm	N/A	N/A	N/A	
	Sensor Error Alarm	Y	Y	Y	
	Low Battery Alarm	Y	Y	Y	
	High Ambient Temperature Alarm	Y	Y	Y	
	Door Ajar Alarm	Y	Y	Y	
Start-up delay	Y	Y	Y		
Accessories	Caster	Y(4)	Y(4)	Y(4)	
	Leveling feet	Y(2)	Y(2)	Y(2)	
	Porthole	2×rear, (25mm)diameter	2×rear, (25mm)diameter	2×rear, (25mm)diameter	
	Inner Doors	2	4	4	
	Shelves	3- stainless steel adjustable shelves	3- stainless steel adjustable shelves	3- stainless steel adjustable shelves	
	Shelf Dimensions(W×D)(mm)	451×597	606×650	752×650	
	Max. Load per Shelf(kg)	44	72	90	
	Freezer Racks Qty(2" boxes)	12	16	20	
	Capacity(2" boxes)	216	400	500	
	USB Interface	Y	Y	Y	
	Remote Alarm	Y	Y	Y	
	5V Power Supply Port	Y	Y	Y	
	Temperature Chart Recorder	Optional	Optional	Optional	
	RS232/485 Port	Optional	Optional	Optional	
	CO <sub>2</sub> Backup System	Optional	Optional	Optional	
LN <sub>2</sub> Backup System	Optional	Optional	Optional		
Others	Certification	UL	UL	UL	

\*Haier Biomedical reserves the right to change products and specifications without prior notice.